

## <sup>13</sup>C respiratory test – Helicobacter pylori

### <sup>13</sup>C respiratory test-set (56)

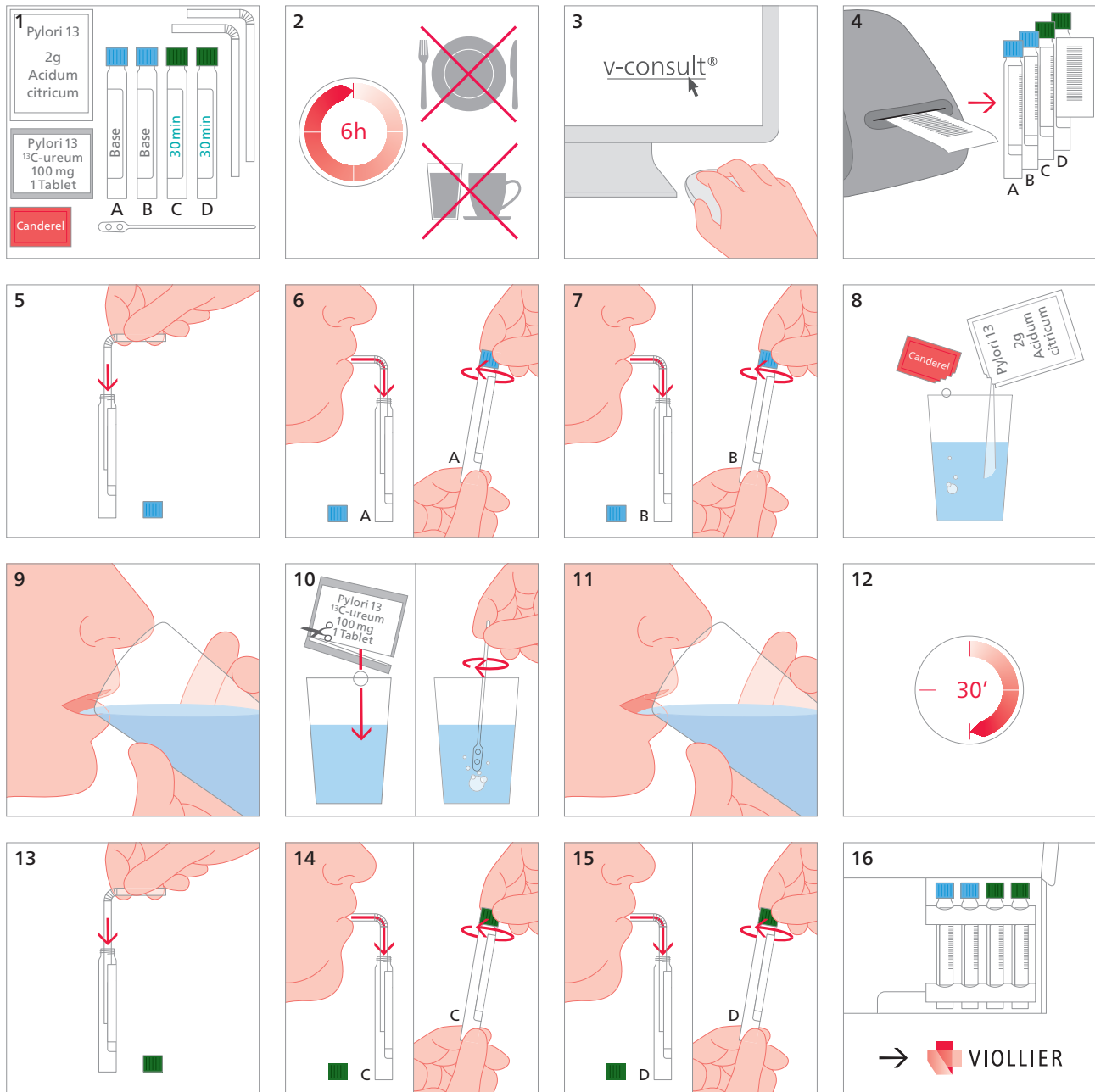

- 5 – 7 Deeply inhale, expire slowly and **completely (residual air)** blow through the straw into the blue tubes, close immediately
- 8 – 9 Dissolve 2 g citric acid (and, if desired, the sweetener tabs) in 100 mL H<sub>2</sub>O and drink **completely**
- 10 – 11 Dissolve urea tablet (Urea <sup>13</sup>C Tablet) in 100 mL H<sub>2</sub>O and drink **completely**
- 12 **wait 30 minutes**
- 13 – 15 Deeply inhale, expire slowly and **completely (residual air)** blow through the straw into the green tubes, close immediately

Shipping material:

Please label with name, first names and date of birth of the patient