

Instructions

Pulse oximetry

Patient record

Please inform the patient about the diagnostic importance of filling out the patient record correctly and completely.

- Please use a black ballpoint pen, not a pencil
- Note start and end of recording with date and time

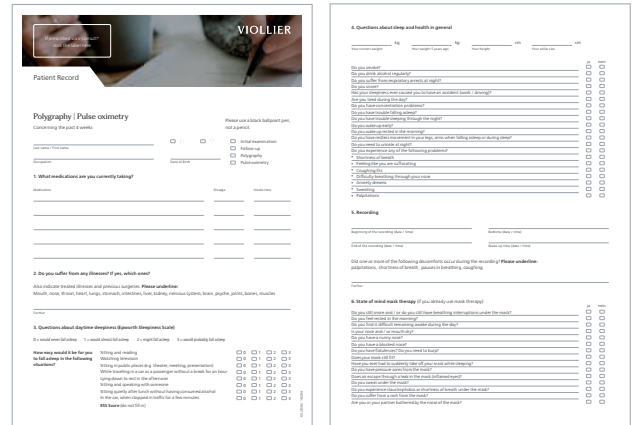

Identification and analysis

- Patient's personal details
- The date and exact start time of the recording, entered by you
- The device and finger sensor numbers entered by Viollier on the order form



Please only use the enclosed order form, as this already has your address on it

- If prescribed via v-consult®: print labels and stick them on all documents

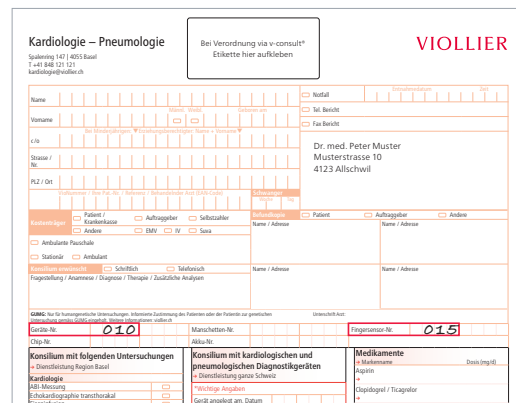

Return

After completing the recording, please return the device with plugged-in cables, strap, Velcro strap, oxygen saturation sensor, order form and patient record. Viollier will cover the shipping costs.

Die Versandkosten übernimmt Viollier.

- By customer service – return to practice
- By DPD – drop off at a pickup parcelshop → dpdgroup.com/ch/mydpd/parcel-shops
- By mail

Please note the following instructions for the return of the box:

- Remove label from window
- Slide the appropriate return label (in the case) into the window → **Viollier AG address is visible**
- Close case with red clip

Important information

- **Do not test start the device**
→ **The device cannot be switched off again**
- Remove nail polish, gel nails and fingernail attachments before the examination
- Do not put the oxygen saturation sensor on the same limb as the 24h blood pressure device cuff if these two devices are worn at the same time

- Mount and start the device before going to bed
- Recording time max. 8 hours, suitable for patients weighing 20 kg and over
- Do not use in the vicinity of CT, MRI and X-rays
- Mobile phones, strong electromagnetic sources and electric blankets can affect the quality of the recording

Attaching the monitor

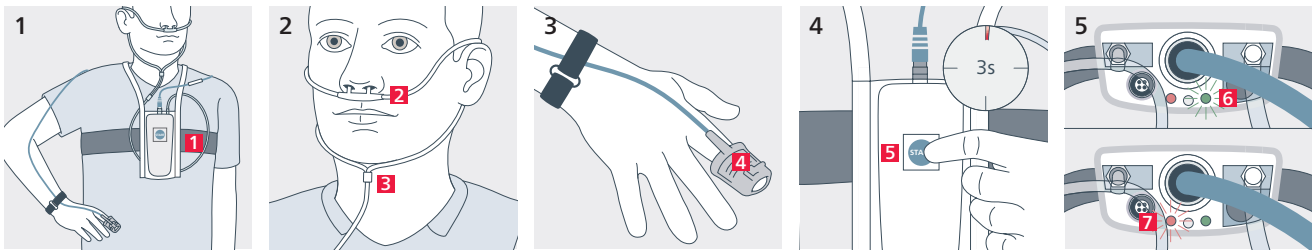

► VIOLLIER

1 – 2 Mounting the device before going to bed

- Do not wear the device and chest strap directly on the skin
- Pull the neck strap and the device over the head
- Fix the device centrally at sternum height using the chest strap **1**
→ at the level of the nipples for men and on the upper part of the chest for women
- Tighten the strap, but not so much that breathing is restricted
- Place the nasal sensor underneath the nose. Position the opening **2** at the nostrils
- Feed the tubes behind the ears, pull the slide **3** up under the chin and adjust

3 Fitting the finger sensor

- Mount the oxygen saturation sensor on your finger with the fingernail symbol facing upward. Pull the finger sensor over the finger until the fingertip is visible
→ The finger sensor **4** may be switched from one finger to another during the night
- **Suitable fingers: index, middle and ring fingers (without nail polish, gel nails or fingernail attachments)**
- Fix the sensor cable to the wrist with the Velcro strap
- If the finger sensor comes off at night, please reattach it

4 – 5 Starting the device

- Press the front **blue start button 5** for 3 seconds
- During recording, the **green light 6** flashes every four seconds.
If a **red light 7** appears next to it, then the finger sensor is not correctly positioned → please correct this
- In the morning dismount the device and return. **Device switches off automatically after 8 hours**



Accessories

- Device with bag and neck strap
- Adjustable chest strap (long)
- Oxygen saturation sensor with plugged-in connection cable and Velcro strap (short) for fixation to the wrist
- Nose sensor with plugged-in connection cable
- Order form, patient record and instructions
- Red closure clip for the return